



WISKIND 万事达



WISKIND

高端集成房屋一体化解决方案服务商

WISKIND MODULAR CONTAINER HOUSE

万事达模块化集成箱房

MODULAR
CONTAINER HOUSE

WISKIND
GROUP



扫一扫了解更多

山东万事达建筑钢品股份有限公司
SHANDONG WISKIND STEEL BUILDIND STOCK CO., LTD
Add: 山东省博兴县经济开发区兴博五路800号
Tel: 400.1588.600
Web: www.wiskind.com.cn
Web: www.wiskindsteelstructure.com

万事达控股有限公司
SHANDONG WISKIND HOLDINGS LIMITED
Web: www.jichengfang.com.cn

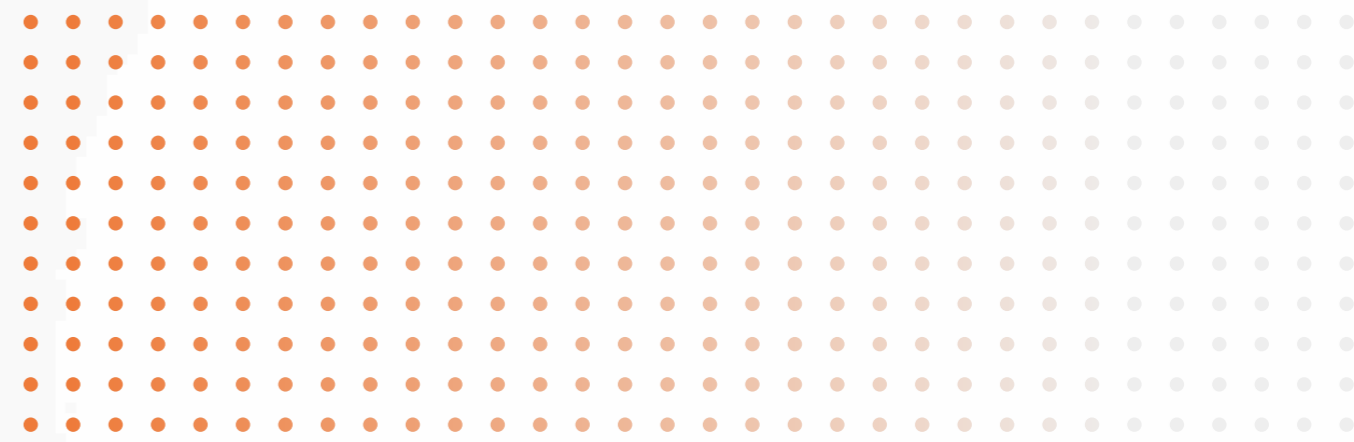

■ ■ HIGH-END
INTEGRATED HOUSE
INTEGRATION
SOLUTION PROVIDER

万事达
高端集成房屋一体化解决方案服务商



WISKIND FACTORY

万事达厂区

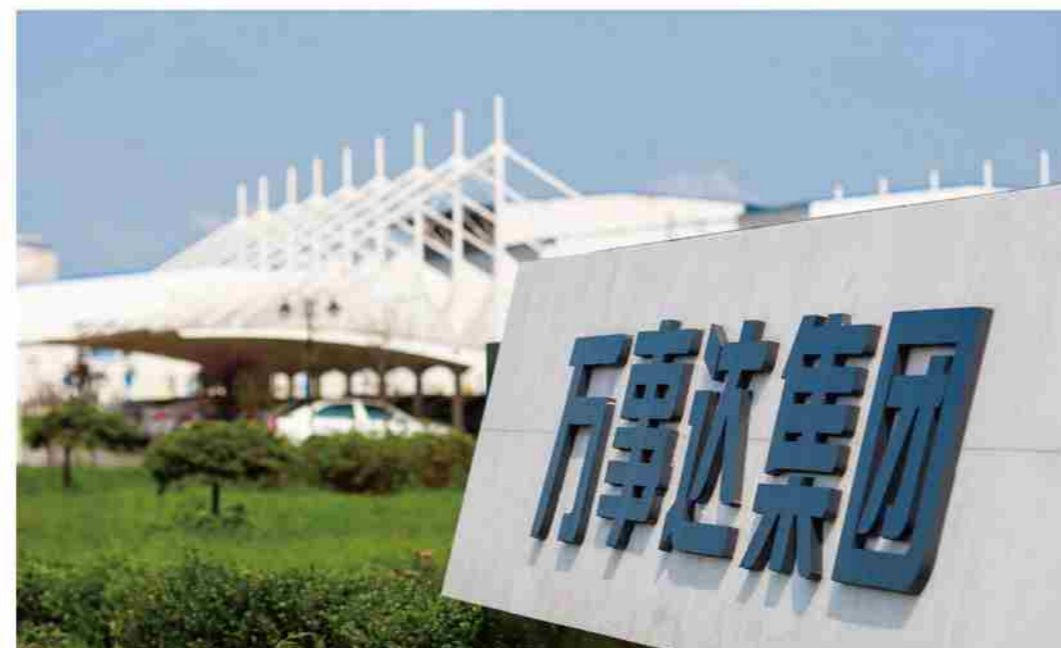



COMPANY CERTIFICATE

公司资质



一种带阳台的模块化房屋及建筑
Modular house and building with balcony



一种支撑件和带阳台的模块化房屋
Support and modular house with balcony



一种模块化房屋对接结构
Modular house docking structure



一种适合活动房屋上隔热断桥窗户上的铝型材
Aluminium profile suitable for thermal insulation broken bridge windows on mobile houses

中国建筑金属协会集成房屋分会副会长单位
Vice President Unit of Integrated House Branch of China Construction Metal Association

中国建筑金属结构协会副会长单位
Vice President Unit of China Construction Metal Structure Association



OHSAS18001 中国职业健康安全管理体系认证证书
OHSAS18001 China Occupational Health and Safety Management System Certification Certificate



IOS14001 环境管理体系认证企业
IOS14001 Environmental Management System Certified Enterprise



ISO9001 质量管理体系双认证企业
ISO9001 Quality Management System Double Certified Enterprise



FM认证
FM certification



高新技术企业
High-tech enterprises



ADVANTAGES OF MODULAR CONTAINER HOUSE

产品优势

HIGH INSTALLATION EFFICIENCY

安装效率高

集成箱房工厂化预制程度高, 现场工作内容较少, 施工快安装效率高。
Modular container house is highly prefabricated. It is easy for installation at site.



LOW TRANSPORTATION COST

运输成本低

可分系统打包 也可整体运输 节省了大量运输费用。
It can be packaged in a system or transported as a whole, saving transportation cost.



HIGHLY INTEGRATED

高度集成化

搬迁方便有效的发挥土地的使用价值。
Easy to relocate, and effective use of land.



MODULAR DESIGN

模块化设计

可自由模块化式搭接 定制化程度高。
Free modular stacked, high degree of customization.



PRODUCT COMPOSITION

产品组成

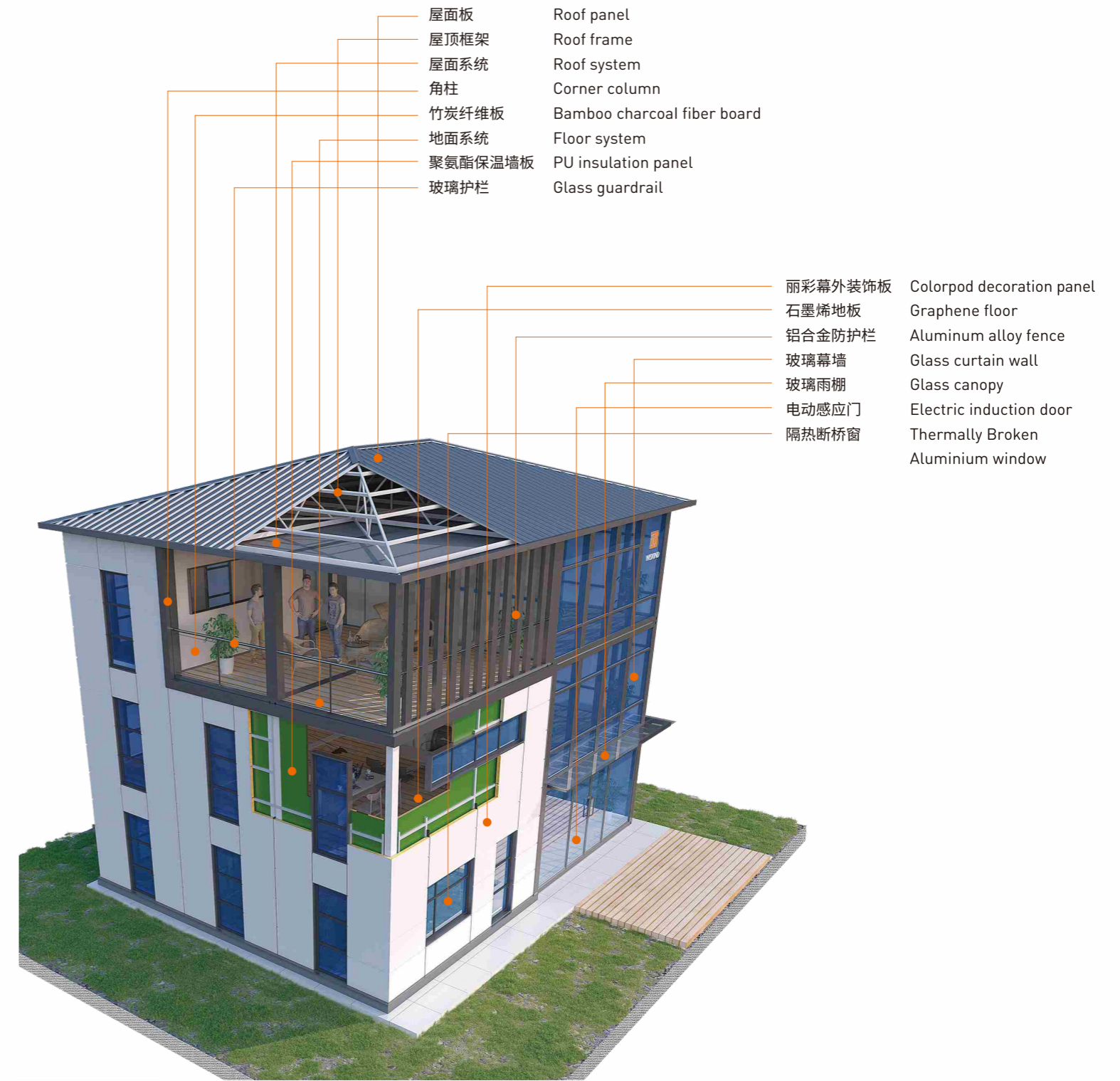



PRODUCT CONFIGURATION

产品配置

PRODUCT DESIGN INSTRUCTION 产品设计说明		
PRODUCT TYPE 产品类型	标准化产品, 具有标准化模数, 以箱体为基本单元, 可单独使用, 及水平、纵向联栋使用, 最高可码放三层。 Standardized products, with standardized modular to the container as the basic unit, can be used alone, and horizontal, vertical use of the Union, the maximum height can be three layers.	
MONOMER SPECIFICATIONS 单体规格	单体长: 6055mm (室内净尺寸5840mm)	Length: 6055mm (indoor net size of 5840mm)
	单体宽: 2435mm (室内净尺寸2220mm) 3000mm (室内净尺寸2800mm)	Width: 2435mm (indoor net size 2220mm) 3000mm (indoor net size 2800mm)
	单体高: 2896mm (室内净尺寸2510mm)	Height: 2896mm (indoor net size 2510mm)

PRODUCT DESIGN INSTRUCTION 产品设计说明		
Frame 框架	热镀锌顶、底型材、立柱连接	Hot galvanized top and bottom profiles Column connection
Room Insulation 房体保温	屋面保温玻璃丝棉双层布置 地面保温玻璃丝棉	Double layers Glass wool for roof insulation Glass wool for floor insulation
Ceiling 吊顶	彩钢条形吊顶板	Color steel plate for ceilings
Floor 地板	环保型塑胶地板	Environmentally friendly plastic flooring
Wall 墙体	夹芯复合板	Sandwich panels
Corematerials of Wall 墙体芯材	玻璃丝绵/岩棉/聚氨酯	Glass wool/ Rock wool/ Polyurethane
Door 门	套装门	Whole set door
Windows 窗	塑钢推拉窗	Plastic sliding window
Electrical 电气	预制电路	Prefabricated circuits
Water Supply 给水	沿墙铺设	Laying along the wall
Drainage 排水	墙侧排水	Draining on the side of the wall

WISKIND CONTAINER HOUSE ADVANTAGE

万事达集成箱房亮点



1

PROFESSIONAL MODULAR CONTAINER HOUSE PLANNING AND DESIGN CAPABILITIES 专业的箱房规划设计能力

设计师均有5-6年的箱房设计经验,可以根据不同的箱房要求,为客户规划出一套完整的箱房解决方案。

The designer has a total of 5-6 years of experience in container house design, and can plan a complete box house solution for customers according to different container house requirements.



2

EXCELLENT CONSTRUCTION EXPERIENCE 卓越的建设经验

公司已研发箱房10余年,拥有丰富的建设经验;万事达集成箱房工厂化预制,现场无需焊接切割,安装快捷,施工周期短。

The company has developed container houses for more than 10 years and has rich construction experience; Wiskind container houses have the factory prefabrication, no welding and cutting are required on site, installation is quick, and the construction period is short.



3

EXCELLENT QUALITY CONTROL 优秀的品控

POLYURETHANE COLD ROOM PANEL 聚氨酯冷库板

- 采用独特的凸凹槽插接方式,提高了板材插口处的密闭性
- 板材均匀稳固,尺寸稳定性好
- 高效保温隔热,防水效果好,绿色环保
- 施工方便,安装便捷
- Unique convex and groove inserting method improves the airtightness of the plate connection.
- The panel is even and stable. The dimensional stability is good.
- High thermal insulation effect, good waterproof effect, eco-friendly.
- Convenient construction, fast installation.

Plate type 板型

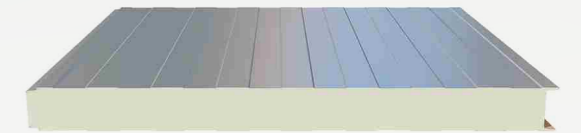

Node figure 节点图

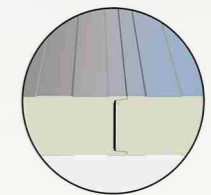

WATERPROOF ROCK WOOL SANDWICH WALL PANEL 憎水岩棉防火墙面板

- 万事达推荐您优选高品质“憎水岩棉”。
- 憎水率大于等于98%,板面更稳定。
- 不产生腐蚀性物质,防水性更佳。
- Wiskind recommends you to select high-quality "waterproof rock wool".
- The hydrophobic rate is not less than 98%, and the panel surface is more stable.
- It does not release corrosive substances, Better waterproof effect.

Plate type 板型



Node figure 节点图

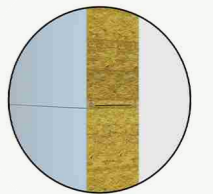



GALVANIZED FRAME 镀锌框架

结构计算采用同济大学研发的3D3S钢结构软件及建研院的PKPM软件，确保结构的安全性。原材料镀锌钢带经辊压成型机组通过计算机程序编程分别压制成型顶框梁、底框梁、角柱等，部件打磨焊接后经自动化喷漆、晾干，组装成顶框、底框。主体框架中增大了天沟尺寸，减缓排水管压力，加强了顶梁强度，使得抗风、抗震性能优越，使用寿命20年以上。

The structure part is designed by the 3D3S steel structure software and the PKPM software, which guarantee the safety. The raw material galvanized steel strips are formed into top frame beams, bottom frame beams, corner posts, etc. by rolling forming components through computer program. After the parts are polished and welded, they are automatically painted, dried, and assembled into top and bottom frames. The size of the gutter is increased, the pressure of the drainage pipe is reduced, and the strength of the top beam is strengthened, so that the wind resistance and seismic performance are superior, and the service life is more than 20 years.



LABORATORY 实验室

公司拥有各类先进的实验器材，实行国际标准的操作规范。产品质量管控分为原材检验、辅材检验、产品检测、工艺稽核、实验室检验等五大工作模块，真正实现从原材料进厂，生产环节，到制成品检验全过程的无缝品质管控，确保产品质量稳定。

The company has all kinds of advanced laboratory equipment and implements international standard operating specifications. Product quality control is divided into five major work modules: raw material inspection, auxiliary material inspection, product inspection, process audit and laboratory inspection, and truly realize seamless quality control throughout the entire process from raw material entering the factory, production substitution, to finished product inspection. Ensure product quality is stable.



PAPAMETERS 相关参数

PRODUCT CATEGORY 产品类别	PRODUCT MODEL 产品型号	EFFECTIVE- WIDTH 有效宽度(mm)	STEEL PLATE THICKNESS 钢板厚度(mm)	CORE THICKNESS 芯材厚度(mm)	RECOMMEND STEEL PLATES 钢板推荐
Polyurethane cold room panel 聚氨酯冷库板	WSD-930	930	0.4-0.8	50/75/100/120/ 150/180/200	Bao Steel,Yieh Phui Steel,BHP Steel 宝钢/烨辉/博思格等
	WSD-1000	1000	0.4-0.8	50/75/100/120/ 150/180/200	Bao Steel,Yieh Phui Steel,BHP Steel 宝钢/烨辉/博思格等
Waterproof rock wool sandwich wall panel 憎水岩棉防火墙面板	WSD-950	950	0.4-0.6	50/75/100/150/200	Bao Steel,Yieh Phui Steel,BHP Steel 宝钢/烨辉/博思格等
	WSD-1150	1150	0.4-0.6	50/75/100/150/200	Bao Steel,Yieh Phui Steel,BHP Steel 宝钢/烨辉/博思格等

CONTAINER HOUSE PROJECT DISPLAY

箱房工程展示



**MODULAR CONTAINER
GUARD HOUSE**
门卫箱房



BATHING DISINFECTION ROOM
洗浴消毒房

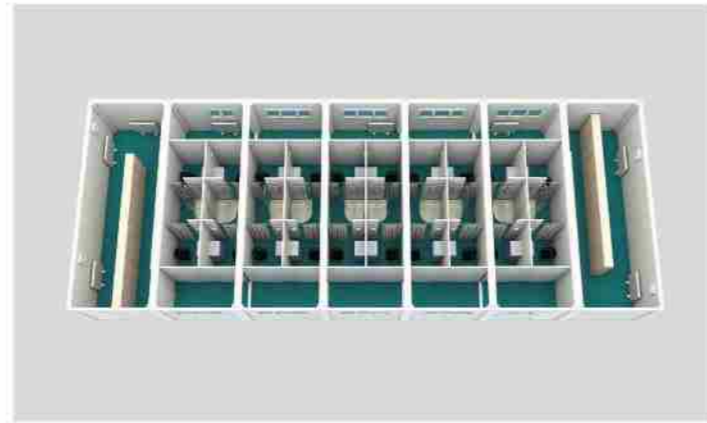

MODULAR CONTAINER HOUSE OFFICE
箱房办公室



WISKIND CONTAINER HOUSE VILLA
万事达箱房别墅





CAMP OFFICE 营地办公房



WISKIND CONTAINER HOUSE VILLA 万事达箱房别墅





**CONTAINER HOUSE
PROJECT DEPARTMENT**
箱房项目部



COMMUNITY MINIATURE FIRE STATION
社区微型消防站

